

| Deer Run (Landbay A) | | | |
|----------------------|----------------|-------|----------|
| PARCEL NAME | TYPE | OWNER | ACCEPTED |
| PARCEL A | PRIVATE STREET | HOA | YES |
| PARCEL B | GREEN/NATURAL | HOA | YES |
| PARCEL C | GREEN/NATURAL | HOA | YES |
| PARCEL D | GREEN/NATURAL | HOA | YES |
| PARCEL E | GREEN | HOA | YES |
| PARCEL F | GREEN | HOA | YES |
| PARCEL G | GREEN | HOA | YES |
| PARCEL H | GREEN/NATURAL | HOA | YES |

| Deer Ridge (Landbay C) | | | |
|------------------------|----------------|-------|----------|
| PARCEL NAME | TYPE | OWNER | ACCEPTED |
| PARCEL A | PRIVATE STREET | HOA | YES |
| PARCEL B | GREEN | HOA | YES |
| PARCEL C | GREEN | HOA | YES |
| PARCEL D | GREEN | HOA | YES |
| PARCEL E | GREEN | HOA | YES |
| PARCEL F | GREEN/NATURAL | HOA | YES |

| Lake View (Landbay F) | | | |
|-----------------------|----------------|-------|----------|
| PARCEL NAME | TYPE | OWNER | ACCEPTED |
| PARCEL A | PRIVATE STREET | HOA | 8/4/2017 |
| PARCEL B | GREEN | HOA | 8/4/2017 |
| PARCEL C | GREEN | HOA | 8/4/2017 |
| PARCEL D | GREEN | HOA | 8/4/2017 |
| PARCEL E | GREEN | HOA | 8/4/2017 |
| PARCEL F | GREEN | HOA | 8/4/2017 |
| PARCEL G | GREEN | HOA | 8/4/2017 |
| PARCEL H | GREEN | HOA | 8/4/2017 |

| Piney Valley (Landbay I) | | | |
|--------------------------|----------------|-------|----------|
| PARCEL NAME | TYPE | OWNER | ACCEPTED |
| PARCEL A | PRIVATE STREET | HOA | YES |
| PARCEL B | GREEN | HOA | YES |
| PARCEL C | GREEN/NATURAL | HOA | YES |

| Queen Anne Turn (Landbay M) | | | |
|-----------------------------|----------------|-------|----------|
| PARCEL NAME | TYPE | OWNER | ACCEPTED |
| PARCEL A | PRIVATE STREET | HOA | 8/4/2017 |
| PARCEL B | GREEN | HOA | 8/4/2017 |
| PARCEL C | GREEN/NATURAL | HOA | 8/4/2017 |
| PARCEL D | GREEN/NATURAL | HOA | 8/4/2017 |
| PARCEL E | GREEN | HOA | 8/4/2017 |
| PARCEL F | GREEN | HOA | 8/4/2017 |

| Fox Hill (Landbay P) | | | |
|----------------------|----------------|-------|----------|
| PARCEL NAME | TYPE | OWNER | ACCEPTED |
| PARCEL A | PRIVATE STREET | HOA | HOA |
| PARCEL B | GREEN | HOA | HOA |
| PARCEL C | GREEN | HOA | HOA |
| PARCEL D | GREEN | HOA | HOA |
| PARCEL E | GREEN/NATURAL | HOA | HOA |
| PARCEL F | GREEN/NATURAL | HOA | HOA |
| PARCEL G | GREEN/NATURAL | HOA | HOA |

| Deer Run Estates (Landbay B) | | | |
|------------------------------|----------------|-------|----------|
| PARCEL NAME | TYPE | OWNER | ACCEPTED |
| PARCEL A | PRIVATE STREET | HOA | YES |
| PARCEL B | GREEN/NATURAL | HOA | YES |
| PARCEL C | GREEN | HOA | YES |
| PARCEL D | GREEN/NATURAL | HOA | YES |
| PARCEL E | GREEN/NATURAL | HOA | YES |

| Deer Valley (Landbay D) | | | |
|-------------------------|----------------|-------|----------|
| PARCEL NAME | TYPE | OWNER | ACCEPTED |
| PARCEL A | PRIVATE STREET | HOA | 8/4/2017 |
| PARCEL B | NATURAL | HOA | 8/4/2017 |
| PARCEL C | NATURAL | HOA | 8/4/2017 |
| PARCEL D | NATURAL | HOA | 8/4/2017 |
| PARCEL E | GREEN | HOA | 8/4/2017 |
| PARCEL F | GREEN/NATURAL | HOA | 8/4/2017 |

| Club House Terrace (Landbay G) | | | |
|--------------------------------|----------------|-------|----------|
| PARCEL NAME | TYPE | OWNER | ACCEPTED |
| PARCEL A | PRIVATE STREET | HOA | YES |
| PARCEL B | GREEN/NATURAL | HOA | YES |

| Oak Hill (Landbay J) | | | |
|----------------------|----------------|-------|----------|
| PARCEL NAME | TYPE | OWNER | ACCEPTED |
| PARCEL A | PRIVATE STREET | HOA | YES |
| PARCEL B | GREEN | HOA | YES |
| PARCEL F | GREEN/NATURAL | HOA | YES |

| Players View (Landbay N) | | | |
|--------------------------|----------------|-------|----------|
| PARCEL NAME | TYPE | OWNER | ACCEPTED |
| PARCEL A | PRIVATE STREET | HOA | HOA |
| PARCEL B | GREEN/NATURAL | HOA | HOA |
| PARCEL C | GREEN/NATURAL | HOA | HOA |
| PARCEL D | GREEN/NATURAL | HOA | HOA |

| Fox Den (Landbay Q) | | | |
|---------------------|----------------|-------|----------|
| PARCEL NAME | TYPE | OWNER | ACCEPTED |
| PARCEL A | PRIVATE STREET | HOA | HOA |
| PARCEL B | GREEN/NATURAL | HOA | HOA |
| PARCEL C | GREEN/NATURAL | HOA | HOA |

| Poplar Turn (Landbay E) | | | |
|-------------------------|----------------|-------|----------|
| PARCEL NAME | TYPE | OWNER | ACCEPTED |
| PARCEL A | PRIVATE STREET | HOA | 8/4/2017 |
| PARCEL B | GREEN/NATURAL | HOA | 8/4/2017 |
| PARCEL C | GREEN/NATURAL | HOA | 8/4/2017 |

| Club House Square (Landbay H) | | | |
|-------------------------------|---------------|-------|----------|
| PARCEL NAME | TYPE | OWNER | ACCEPTED |
| PARCEL A | GREEN/NATURAL | HOA | YES |

| Eagle Ridge (Landbay K) | | | |
|-------------------------|----------------|-------|----------|
| PARCEL NAME | TYPE | OWNER | ACCEPTED |
| PARCEL A | PRIVATE STREET | HOA | 8/4/2017 |
| PARCEL D-1 | GREEN/NATURAL | HOA | 8/4/2017 |
| PARCEL H | GREEN | HOA | 8/4/2017 |

| Cedar Creek (Landbay L) | | | |
|-------------------------|----------------|-------|----------|
| PARCEL NAME | TYPE | OWNER | ACCEPTED |
| PARCEL A | PRIVATE STREET | HOA | 8/4/2017 |
| PARCEL B | GREEN | HOA | 8/4/2017 |

| Fox Turn (Landbay O) | | | |
|----------------------|----------------|-------|----------|
| PARCEL NAME | TYPE | OWNER | ACCEPTED |
| PO PARCEL A | PRIVATE STREET | HOA | HOA |
| PO PARCEL B | GREEN/NATURAL | HOA | HOA |
| PO PARCEL C | GREEN/NATURAL | HOA | HOA |
| PO PARCEL D | GREEN/NATURAL | HOA | HOA |
| PO PARCEL E | GREEN/NATURAL | HOA | HOA |
| PO PARCEL F | GREEN/NATURAL | HOA | HOA |
| PO PARCEL G | GREEN | HOA | HOA |

| Bowville | | | |
|-------------|----------------|-------|----------|
| PARCEL NAME | TYPE | OWNER | ACCEPTED |
| PARCEL A | PRIVATE STREET | HOA | YES |
| PARCEL B | GREEN/NATURAL | HOA | YES |
| PARCEL F | PRIVATE STREET | HOA | YES |
| PARCEL H | PRIVATE STREET | HOA | YES |
| PARCEL I | GREEN/NATURAL | HOA | YES |
| PARCEL J | PRIVATE STREET | HOA | YES |

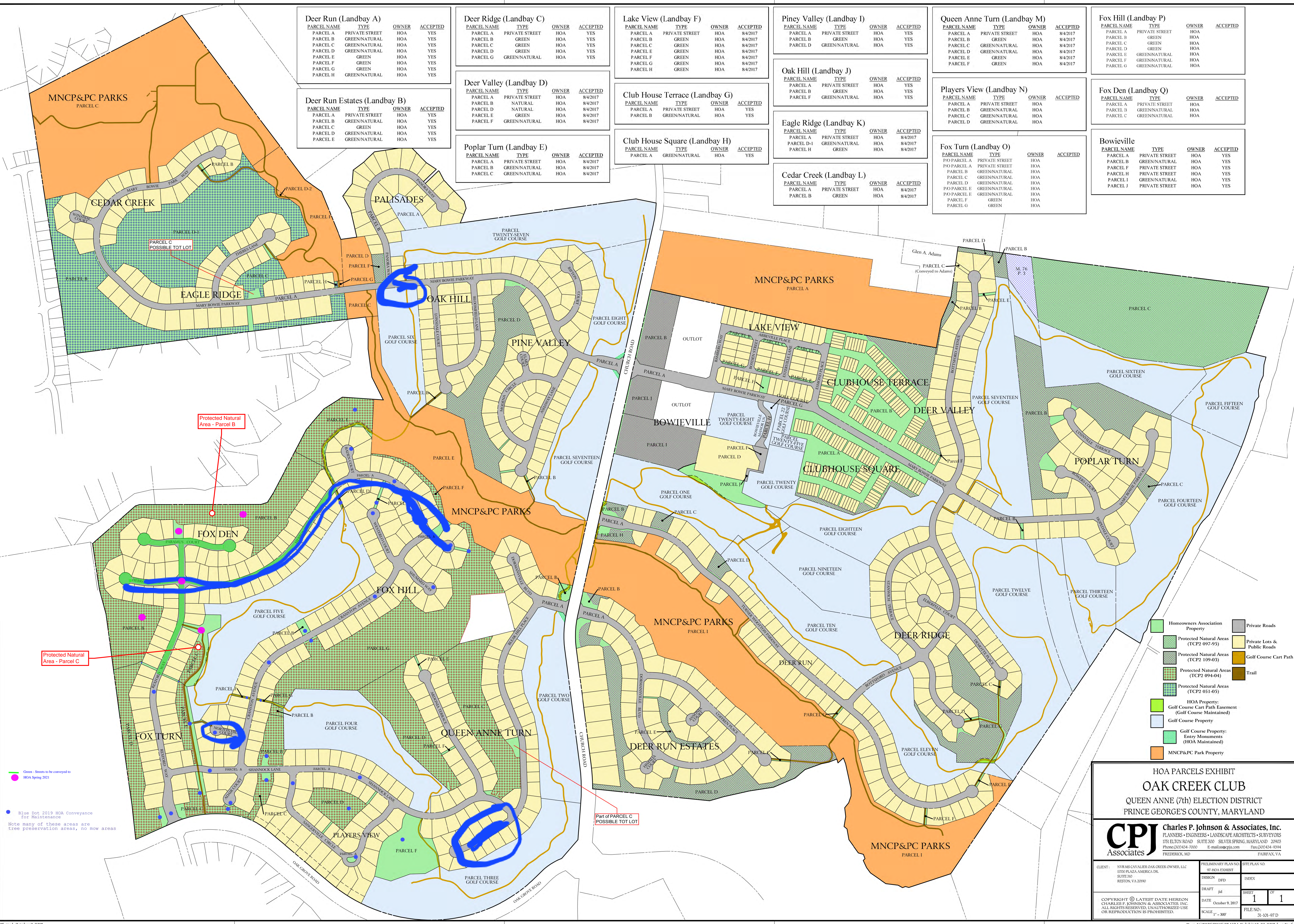

- Homeowners Association Property
- Protected Natural Areas (TCP2 097-95)
- Protected Natural Areas (TCP2 109-03)
- Protected Natural Areas (TCP2 094-04)
- Protected Natural Areas (TCP2 031-05)
- Golf Course Cart Path Easement (Golf Course Maintained)
- Golf Course Property
- Golf Course Property: Entry Monuments (HOA Maintained)
- MNCP&PC Park Property
- Private Roads
- Private Lots & Public Roads
- Golf Course Cart Path
- Trail

Green - Streets to be conveyed to HOA Spring 2021

Blue Dot - 2019 HOA Conveyance for Maintenance

Note many of these areas are tree preservation areas, no mow areas

HOA PARCELS EXHIBIT
OAK CREEK CLUB
 QUEEN ANNE (7th) ELECTION DISTRICT
 PRINCE GEORGE'S COUNTY, MARYLAND

CPJ Associates Charles P. Johnson & Associates, Inc.
 PLANNERS • ENGINEERS • LANDSCAPE ARCHITECTS • SURVEYORS
 1751 ELTON ROAD SUITE 300 SILVER SPRING, MARYLAND 20903
 Phone: (301) 454-7000 E-mail: cpj@cpj.com Fax: (301) 454-9294
 FREDERICK, MD FAIRFAX, VA

| | | |
|---|--|---------------|
| CLIENT: NVRMS CAVALLIER OAK CREEK OWNER, LLC 1030 PLAZA AMERICA DR. SUITE 310 RESTON, VA 20190 | PRELIMINARY PLAN NO. 97-HOA EXHIBIT | SITE PLAN NO. |
| DESIGN: dfd | INDEX: | |
| DRAFT: jid | SHEET: 1 | OF: 1 |
| DATE: October 9, 2017 | FILE NO.: | |
| SCALE: 1" = 300' | | SI-101-97-D |

COPYRIGHT © LATEST DATE HEREON CHARLES P. JOHNSON & ASSOCIATES, INC. ALL RIGHTS RESERVED. UNAUTHORIZED USE OR REPRODUCTION IS PROHIBITED.

Dwg: N:\S101\DWG\97-HOA Exhibit 10-09-2017.dwg Xref: